



### Double Decker 50kg and 100kg models

Model	Total Capacity	Car			Car Entrance		Serving Height		Shaft		Pit Depth	Head-room
		Width	Depth	Height	Width	Height	Top	Bottom	Width	Depth		
<b>50B DD</b>	100kg	520	520	800	420	770	1010	Floor	800	800	400*	3000†
<b>50C DD</b>	100kg	620	620	800	520	770	1010	Floor	900	900	400*	3000†
<b>100A DD</b>	100kg	720	720	800	620	770	1010	Floor	1000	1000	400*	3000†
<b>100B DD</b>	100kg	820	820	800	720	770	1010	Floor	1100	1100	400*	3000†

#### Notes:

The above table shows our standard models. If you require a lift with specific dimensions manufactured for you, please contact us for details. All dimensions in mm. Car and Entrance dimensions on Double Decker models are nominal.

\* A reduction in pit depth is possible – please contact us for details.

† A reduction in headroom may be available – please contact us for details.

#### Important notice

This data sheet is for guidance only and must not be used for proper working drawings.

Please contact Stannah for particular details before proceeding. Owing to our policy of continual improvement, we reserve the right to alter specifications and dimensions without prior notice.

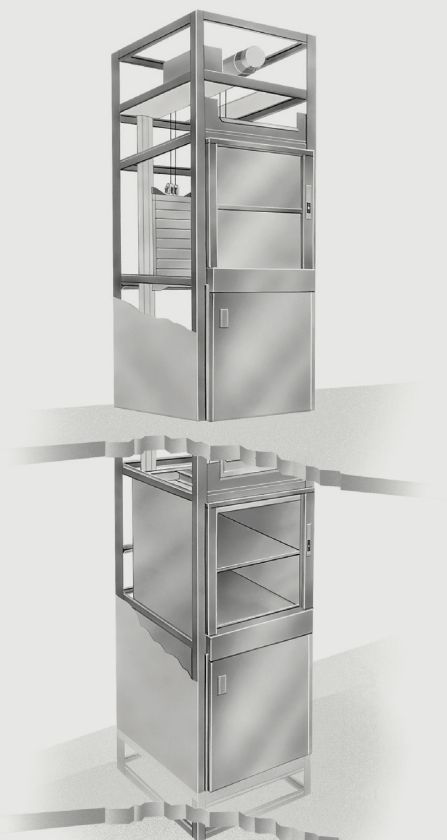

#### Choice of entrance configurations:

Entrances are available on up to two sides – please call us for further information.

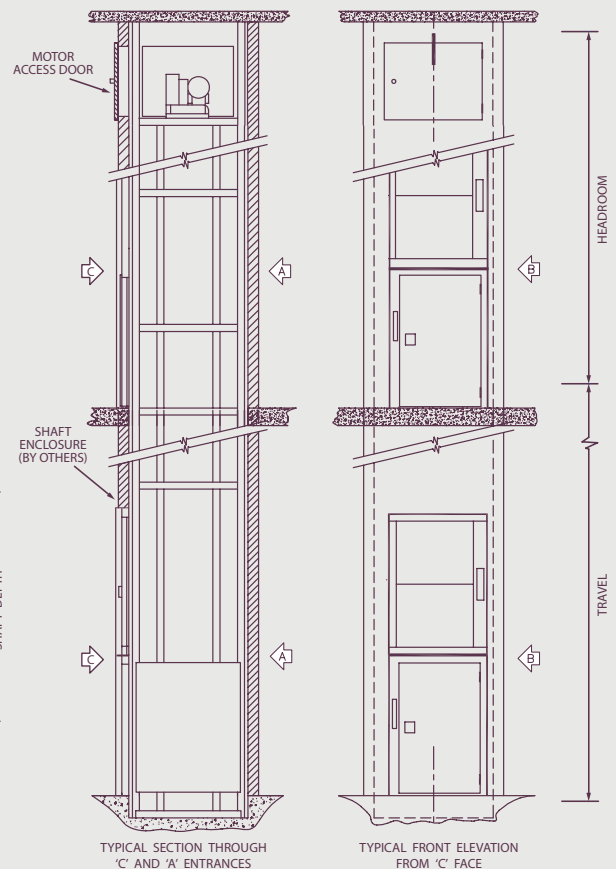
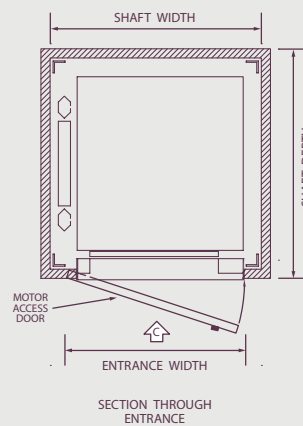

# Stannah Microlift

## Engineering data 50kg and 100kg Double Decker

### Specification

- Car:** Two lift cars in one Double Decker allows two loads to travel at once. The cars are constructed in stainless steel and the upper car only has a removable stainless steel shelf.
- Speed:** 0.35m/s
- Entrances:** The upper landing entrances are protected by high quality rise and fall shutters which are fitted with safety locks and finished in stainless steel. The lower landing entrances are protected by hinged door with a stainless steel finish.
- Car entrance protection:** The upper lift car entrance is protected by a rise and fall shutter, the lower entrance by a collapsible car gate. Protecting the car entrance prevents goods from falling while the lift is in motion.
- Entry choice:** Entrances are available on up to two sides – please refer to the diagram overleaf for more information.
- Control:** Fully automatic push button control with call and send buttons at each entrance for ease of use.
- Indicators:** “Lift arrival”, “lift occupied” and “lift position” indicators are fitted at each entrance, together with an audible lift arrival buzzer.
- Travel:** Up to 12 stops over a total distance of 30m of travel. 30m travel includes pit and headroom height.
- Mounting:** The Microlift is supplied with a structure-supported frame which is galvanised for longer life. We do not require a separate motor room or “load-bearing” lift shaft.
- Motor:** Mounted at the top of the lift structure, the smooth, quiet motor drives a high quality reduction gearbox fitted with a traction vee-sheave. An electro-magnetic disc brake is supplied, with emergency release mechanism. The reliable controller and counter-balance drive system ensure electrical consumption is minimal.
- Power Supply:** A 415V three-phase supply.

#### Full safety compliance:

Complies with the Essential Safety Requirements (ESRs) of the Supply of Machinery (Safety) Regulations 2008 (2008 No. 1597) and EN 81-3 where applicable.



27551 - MicroliftDoubleDeckerDS-09-2024

### Safe maintenance access

The lift owner is responsible for ensuring a service engineer is able to access the motor compartment in a safe manner.

Access doors to the motor compartment are required on one or two faces of the lift shaft, depending on the configuration of the lift. The doors must be hinged and lockable.

Our builders work drawings contain more detailed information on this topic but please do not hesitate to contact us if you have any questions.

#### Stannah Microlifts

Watt Close, East Portway, Andover, Hampshire SP10 3SD  
Telephone: 01264 351922

[www.stannahlifts.co.uk](http://www.stannahlifts.co.uk)

# Stannah