



**Passenger Lifts
Data sheets**

21-33 Person
Xtralift Core Range

Stannah

21-33 Person Passenger Lift Data Sheets

This technical data provides general guidance on the range of options and sizes available. We also provide CAD blocks and NBS lift specifications on all our products.

We can provide specific site solutions, including for existing lift shafts. For any queries regarding your project, to request budget quotes, or to discuss any detailed specifications please contact the Passenger Lift Technical Sales Team.

Email: sales@stannah.co.uk

Tel: **01264 339090**

CONTENTS

Xtralift Core Lift Range, up to 45m travel

21 person (1600kg) lift dimensions	3
26 person (2000kg) lift dimensions	4
33 person (2500kg) lift dimensions	5

General Information

Lift loads	6
Threshold rebate details	7
Electrical loadings	8



An independent family business since 1867

21 Person (1600 kg) Xtralift Core Range Traction MRL Lift

Stannah

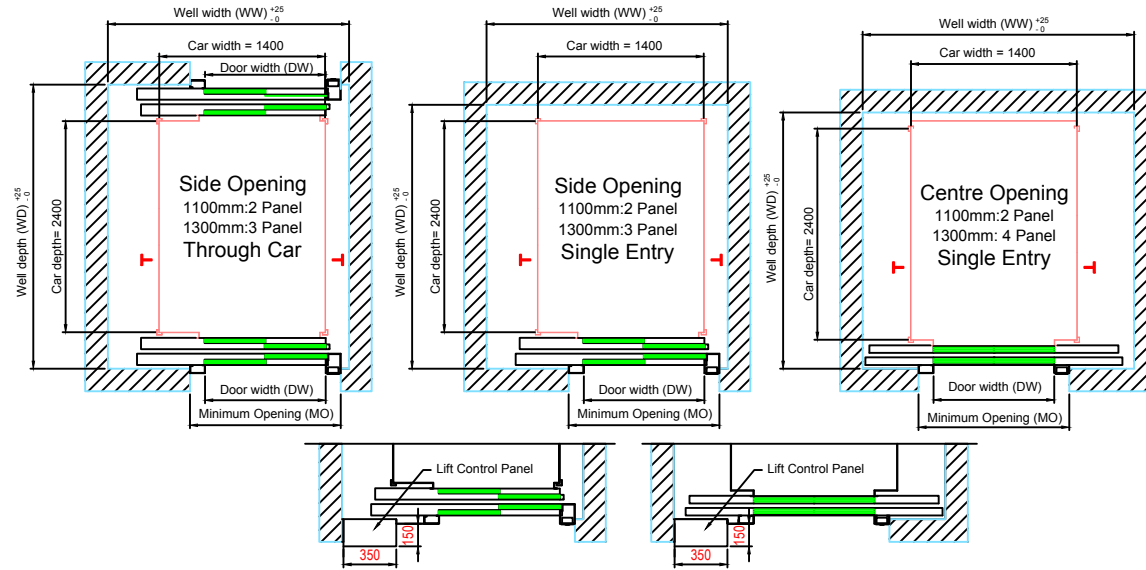
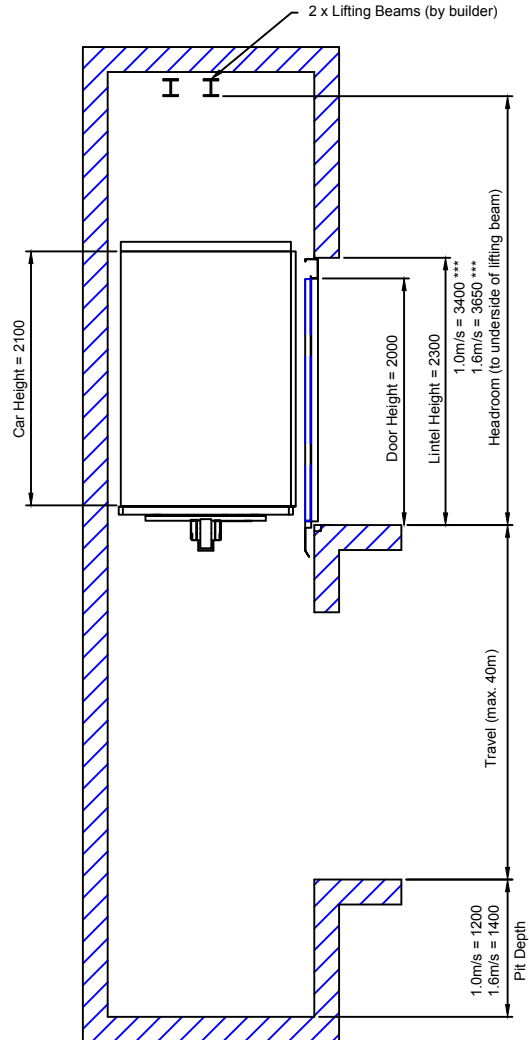

Lift Control Panel located at top floor or one level below. It can be mounted next to the landing entrance or remotely mounted within 3m of the lift shaft

		Shaft Size				
		Single Entrance		Through Entrance		
DW	Door type	WW	WD	WW	WD	MO
1100	Side Opening	2400	2800	2400	2900	1400
	Centre Opening	2450	2800	2450	2900	
1300	Side Opening	2400	2900	2400	3100	1600
	Centre Opening	2400	2850	2400	2900	

Waiver:

We can work to a range of shaft dimension and configurations, including for existing lift shafts. If you're looking for a specific size to fit your project please contact the Passenger Lift Technical Sales Team who'll be able to advise further. This data sheet is for guidance only and must not be used for proper working drawings. Please contact Stannah Lifts for particular details before proceeding. Owing to our policy of continual improvement we reserve the right to alter specifications and dimensions without prior notice.

*** For Centre Opening Doors and for 1300mm side opening doors please add an additional 400mm to the underside of beam and headroom to account for EN81-20 requirements.

Stannah Lifts Ltd.
Watt Close, East Portway,
Andover, Hampshire SP10 3SD
Tel: 01264 339090
sales@stannah.co.uk

Information Sheet
T-21P
28/06/2022

26 Person (2000 kg) Xtralift Core Range Traction MRL Lift

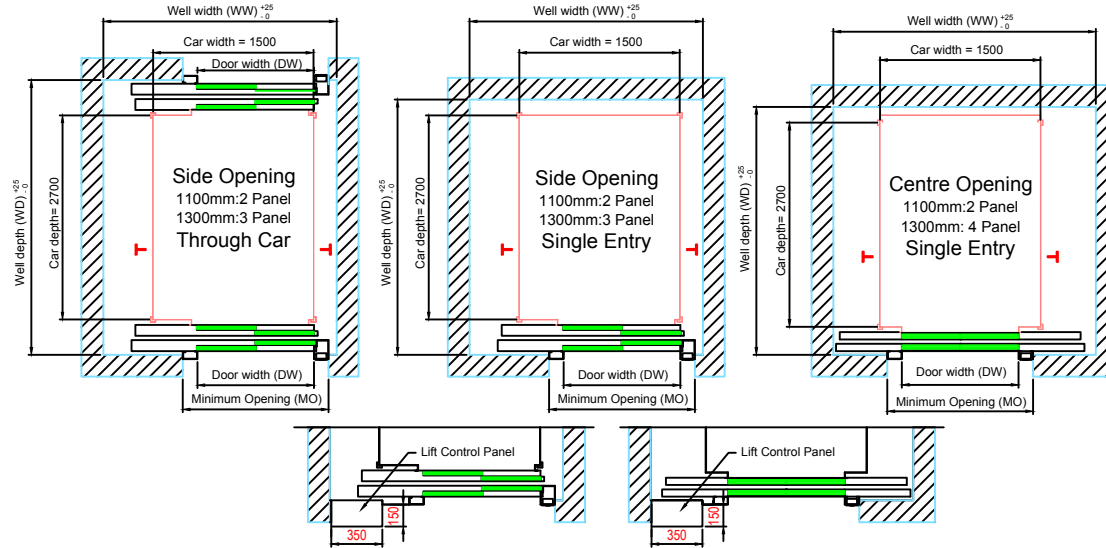
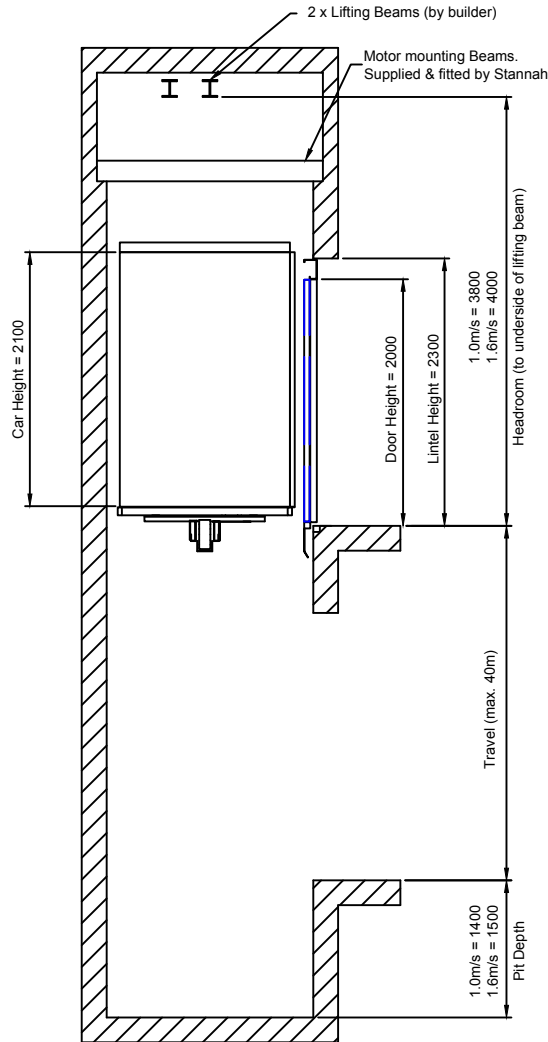

Lift Control Panel located at top floor or one level below. It can be mounted next to the landing entrance or remotely mounted within 3m of the lift shaft

		Shaft Size				
		Single Entrance		Through Entrance		
DW	Door type	WW	WD	WW	WD	MO
1100	Side Opening	2500	3100	2500	3200	1400
	Centre Opening	2550	3100	2550	3150	
1300	Side Opening	2500	3150	2500	3400	1600
	Centre Opening	2500	3100	2500	3250	

Waiver:

We can work to a range of shaft dimension and configurations, including for existing lift shafts. If you're looking for a specific size to fit your project please contact the Passenger Lift Technical Sales Team who'll be able to advise further. This data sheet is for guidance only and must not be used for proper working drawings. Please contact Stannah Lifts for particular details before proceeding. Owing to our policy of continual improvement we reserve the right to alter specifications and dimensions without prior notice.

Stannah Lifts Ltd.
Watt Close, East Portway,
Andover, Hampshire SP10 3SD
Tel: 01264 339090
sales@stannah.co.uk

Information Sheet
T-26P
28/06/2022

33 Person (2500 kg) Xtralift Core Range Traction MRL Lift

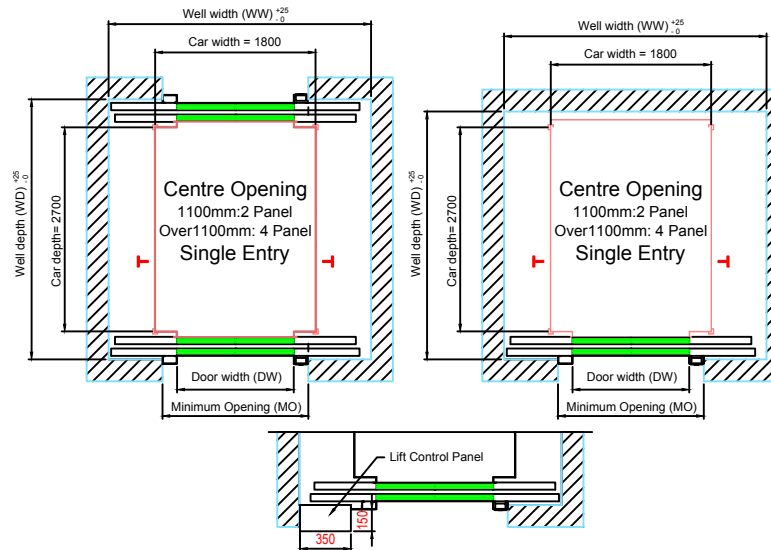
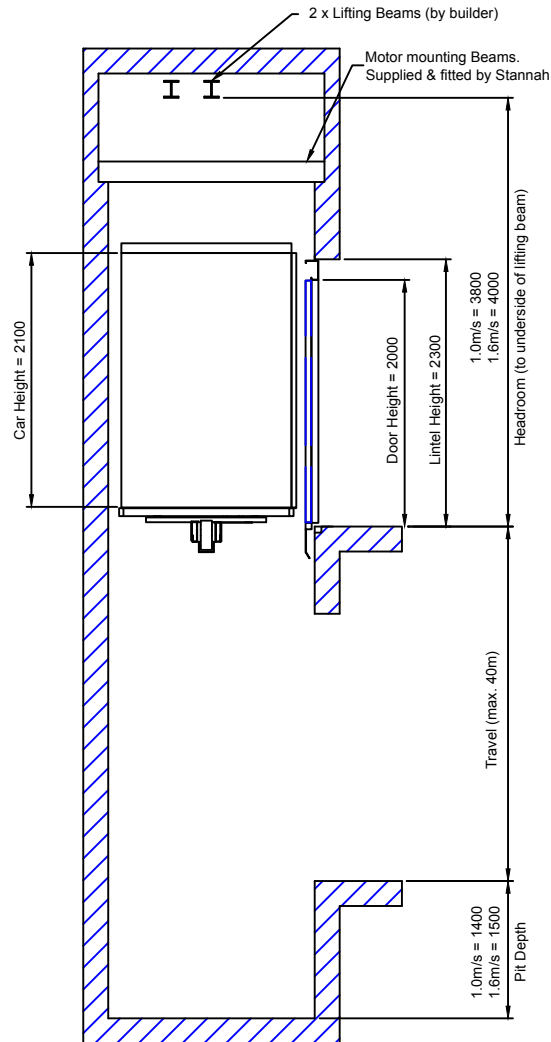

Lift Control Panel located at top floor or one level below. It can be mounted next to the landing entrance or remotely mounted within 3m of the lift shaft

		Shaft Size				
		Single Entrance		Through Entrance		
DW	Door type	WW	WD	WW	WD	MO
1100	Centre Opening	2900	3100	2900	3150	1400
1300	Centre Opening	2900	3100	2900	3250	1600
1400	Centre Opening	2900	3100	2900	3250	1700

Waiver:

We can work to a range of shaft dimension and configurations, including for existing lift shafts. If you're looking for a specific size to fit your project please contact the Passenger Lift Technical Sales Team who'll be able to advise further. This data sheet is for guidance only and must not be used for proper working drawings. Please contact Stannah Lifts for particular details before proceeding. Owing to our policy of continual improvement we reserve the right to alter specifications and dimensions without prior notice.

Stannah Lifts Ltd.
Watt Close, East Portway,
Andover, Hampshire SP10 3SD
Tel: 01264 339090
sales@stannah.co.uk

21-33 Person Lift Loads

Xtralift Core Range

Traction MRL Lift

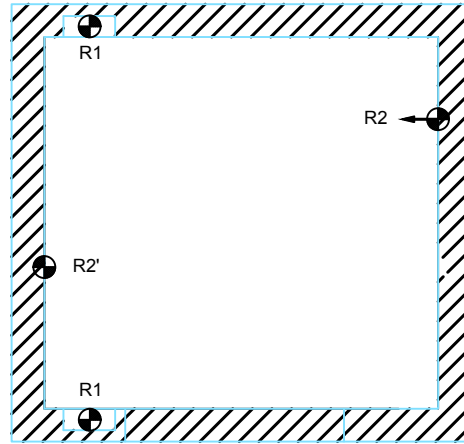

Shaft Head Loading

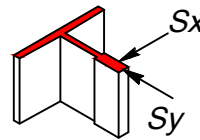

Guide Loads

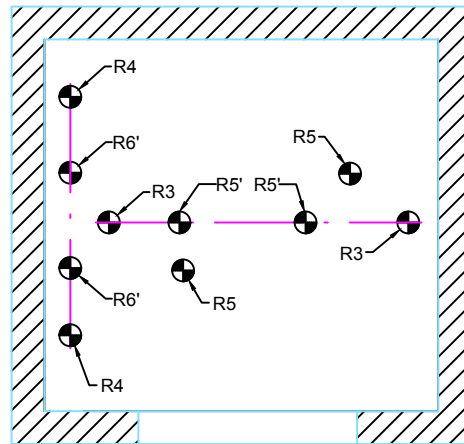

Pit Loading

		EQUIVALENT DEAD LOADS IMPOSED DUE TO LIFT OPERATION (kN)		
		21 Person	26 Person	33 Person
Shaft Head Loadings	R1	-	70	80
	R2	19	23.5	28.5
	R2'	-	18.5	22.25
Pit Floor Loadings	R3	35.5	42.5	49
	R4	2	2	2
	R5	-	74.5	87
	R5'	60	-	-
	R6'	45	55	62.5
Side Wall Loadings	Sx	1.1	1.5	2.2
	Sy	1.9	2.8	3.5

B - Notes:

- R1 = Dead load due to motor mounting beams
- R2 = Dead load due to rope anchorage
- R3 = Dead load due to car plus load under safety gear operation
- R4 = Dead load below counterweight guides
- R5 = Dead load due to car buffering
- R6 = Dead load due to counterweight buffering
- T = Shear load on side wall at each guide bracket
- N = Pull out load on side wall at each guide bracket

Note: Loads R3, R4 and R6 do not act at the same time

The above figures are for guidance only and can change depending on specification and finishes. Specific details will be supplied as part of Stannah Lifts Builders Work Drawing.

Waiver:

We can work to a range of shaft dimension and configurations, including for existing lift shafts. If you're looking for a specific size to fit your project please contact the Passenger Lift Technical Sales Team who'll be able to advise further. This data sheet is for guidance only and must not be used for proper working drawings. Please contact Stannah Lifts for particular details before proceeding. Owing to our policy of continual improvement we reserve the right to alter specifications and dimensions without prior notice.

Stannah Lifts Ltd.
 Watt Close, East Portway,
 Andover, Hampshire SP10 3SD
 Tel: 01264 339090
sales@stannah.co.uk

Information Loadings Sheet **T 21-33**
 28/06/2022

Threshold Rebate Details

Xtralift Core Range and Maxilift Entry Level Range

Traction MRL Lift

Standard Arrangement (Doors mounted within lift shaft)

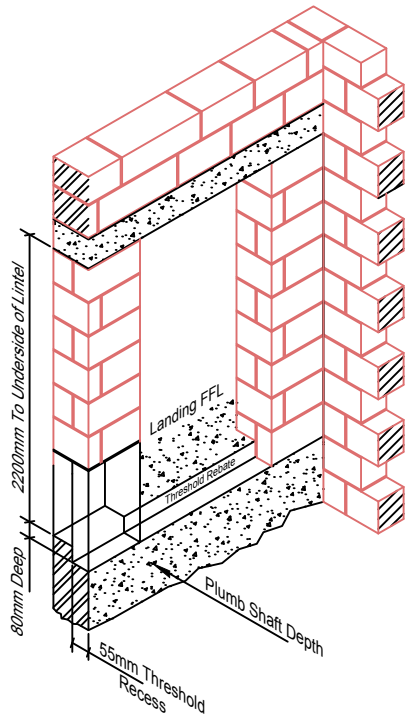

Without Entrance Rebate
(View looking out of shaft)

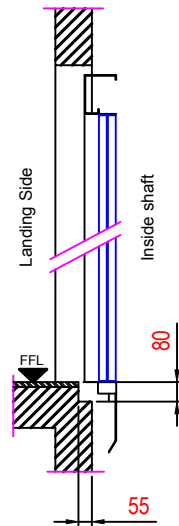

Reduced Shaft Depth Arrangement (Doors mounted on landing)

It is possible to reduce the required shaft depth by mounting the landing entrances on the landing. This can reduce the minimum shaft depth by the depth of the entrance rebate (LD), per entrance (please refer to shaft size data sheets). Please contact Stannah for further details.

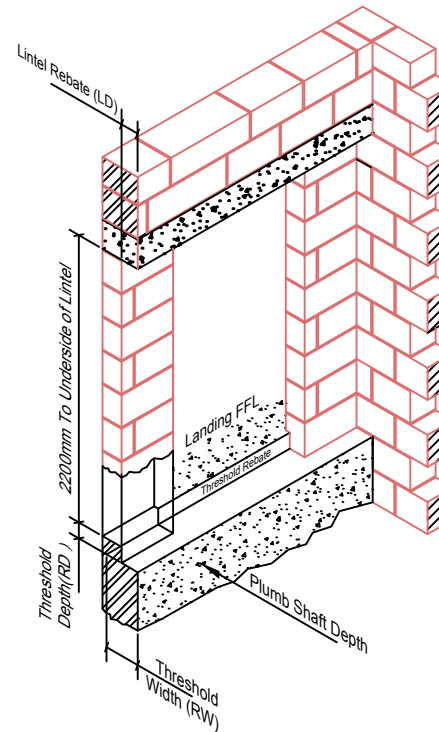

With Entrance Rebate
(View looking out of shaft)

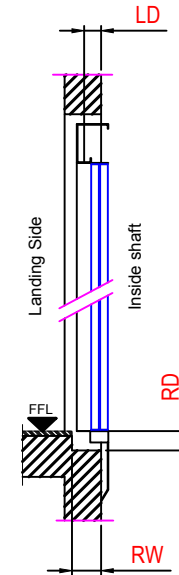

	Threshold Rebate		Entrance Rebate
Door type	RW	RD	LD
Side Opening	120	80	70
Centre Opening	100	80	45

Waiver:

We can work to a range of shaft dimension and configurations, including for existing lift shafts. If you're looking for a specific size to fit your project please contact the Passenger Lift Technical Sales Team who'll be able to advise further. This data sheet is for guidance only and must not be used for proper working drawings. Please contact Stannah Lifts for particular details before proceeding. Owing to our policy of continual improvement we reserve the right to alter specifications and dimensions without prior notice.

Stannah Lifts Ltd.
Watt Close, East Portway,
Andover, Hampshire SP10 3SD
Tel: 01264 339090
sales@stannah.co.uk



Passenger lift Electrical Loadings & Requirements

A permanent motor rated 415V, 3 phase, neutral & earth 50Hz supply shall be provided terminating in a wall mounted socket, suitably rated for the supply and conforming to the IEC 60309 standard, together with a matching plug.

The supply must be rated for the start/run currents stated below, lockable in the 'OFF' position at the building intake room and clearly labelled 'Lift Main Supply'.

		Maxilift Entry-level Range			Xtralift Core Range			Xtralift Core Range		
		1.0 m/s			1.0 m/s			1.6 m/s		
Lift Size	Load (kg)	Motor Power (kW)	Start Current	Nominal Current	Motor Power (kW)	Start Current	Nominal Current	Motor Power (kW)	Start Current	Nominal Current
6 Person	450	4	20.9	11.2	4	20.9	11.2	8	40.0	22.8
8 Person	630	5	26.8	14.1	5	26.8	14.1	8	40.0	22.2
10 Person	800				6	29.7	17.3	12.8	61.6	34.9
13 Person	1000	7	34.0	17.6	7	34.0	17.6	12.8	61.6	34.9
17 Person	1275				10.2	53.5	29.7	17.7	59.4	36
21 Person	1600				19	75.6	32	27.2	96.3	45
26 Person	2000				21.8	77.4	36	35.4	122.4	68
33 Person	2500				21.8	77.4	43	40.8	144.0	80

Please note the electrical loading for an individual passenger lift is affected by travel & weight, the latter of which includes cabin finishes. Due to this we always recommend you refer to the exact specification given on builder's work drawings or speak to your technical sales consultant, particularly if the passenger lift car finishes have, or are likely to be, changed.

Waiver

This data sheet is for guidance only and must not be used for proper working drawings. Please contact Stannah Lifts for particular details before proceeding. Owing to our policy of continual improvement we reserve the right to alter specifications and dimensions without prior notice

Stannah Lifts Ltd.
Watt Close, East Portway,
Andover, Hampshire SP10 3SD
Tel: 01264 339090
sales@stannah.co.uk

Information Sheet
X6-1
28/06/2022



Stannah Lifts

Watt Close, East Portway, Andover, Hampshire SP10 3SD
Telephone: 01264 339090

www.stannahlifts.co.uk

Stannah